

RETAIL & OFFICE SPACE FOR LEASE



RIVERSIDE PLAZA

2851 Riverside Plaza, Steamboat Springs, CO 80487



PROPERTY FEATURES

Convenient access to Steamboat II and growing neighborhoods in West Steamboat. East and west-facing HWY-40 signage. Daily commuters from Hayden, Milner and Craig. Located amongst entertainment options, including Snow Bowl, axe throwing, restaurants and more!
Close to Elk River Road and 5 minutes to downtown Steamboat Springs.

LEASING INFORMATION

Asking Rates: Call for details.
Est. NNN (2024): \$4.11
Lease Terms: 3-5 Years
Max. Contiguous: *Fully Leased!*
Minimum Sq. Ft.: *Fully Leased!*

DEMOGRAPHICS (2024)

 POPULATION	1 MILE:	1,479
	3 MILES:	7,083
	5 MILES:	15,473
 HOUSEHOLDS	1 MILE:	529
	3 MILES:	2,649
	5 MILES:	6,381
 HOUSEHOLD INCOME (MEDIAN)	1 MILE:	\$55,878
	3 MILES:	\$82,476
	5 MILES:	\$93,135



Explore More Western Centers
Leasing Opportunities!

RIVERSIDE PLAZA

2851 Riverside Plaza, Steamboat Springs, CO 80487



SUITE	TENANT	SQ. FT.
100	Steamboat II Metropolitan District	920
110	Enterprise Rent-A-Car	1,800
110B	Storage	342
120	Masterpiece Custom Framing	1,737
130	Christy Sports	11,148
190	The Timber Axe Lounge	3,152
200	Yampa Valley Chiropractic	1,178
210A	Snow Bowl Steamboat Office	517
210B, 230	Colorado Bagel Market & Deli	2,782
220	Iglesia Camino de Liberacion	1,718
240, 250	Four Points Physical Therapy	2,435
250A	Yampa Valley Recycles Depot	641
260	Sk8 Church/ Christ for Life Ministries	4,827

SITE MAP

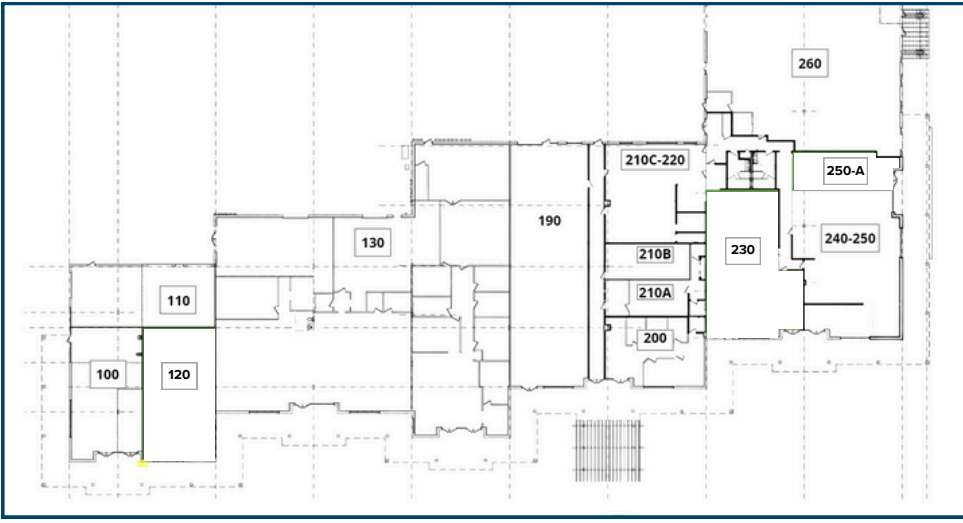

JOIN THESE GREAT TENANTS!



WESTERN CENTERS
10555 E. DARTMOUTH AVE. SUITE 360
AURORA, CO 80014



303.306.1000
LEASING@WESTERNCENTERS.COM
WWW.WESTERNCENTERS.COM